



Rosemary Way, Jaywick, CO15 2SD

£1,150 Per month



A larger-than-average first floor three bedroom flat located on Rosemary Way, Jaywick, available for immediate occupation. The property offers three genuine double bedrooms, making it ideal for families, sharers or anyone needing extra space.

Further benefits include gas central heating, double glazing throughout, and a bright, well-proportioned layout that feels more spacious than a typical flat. Set within a residential area close to local amenities, the beach and transport links.

High demand is expected — viewings are strictly by appointment, so early interest is strongly advised to avoid disappointment.

Bedroom 1

Double Size, window, carpet and gas radiator

Bedroom 2

Double size, window to front, gas radiator, carpet

Lounge

large size, carpet, window to rear

Kitchen/Diner

Induction Oven, cupboards and units with space for white goods. Archway to dining area.

Bedroom 3

Smaller double, bedroom off of living room.

Bathroom

shower over bath, toilet and sink.

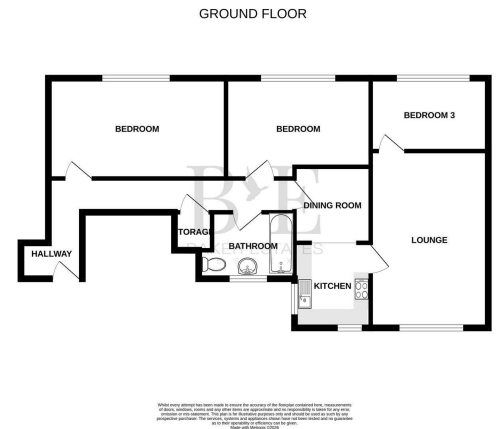
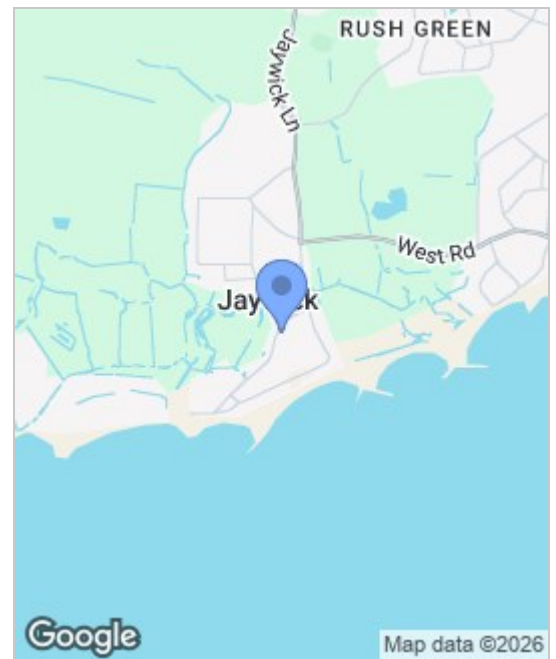

Energy Efficiency Rating		Environmental Impact (CO ₂) Rating	
	Current	Potential	
Very energy efficient - lower running costs			Very environmentally friendly - lower CO ₂ emissions
(92 plus) A			(92 plus) A
(81-91) B			(81-91) B
(69-80) C			(69-80) C
(55-68) D			(55-68) D
(39-54) E			(39-54) E
(21-38) F			(21-38) F
(1-20) G			(1-20) G
Not energy efficient - higher running costs			Not environmentally friendly - higher CO ₂ emissions
England & Wales	EU Directive 2002/91/EC	68	England & Wales
		78	EU Directive 2002/91/EC

These particulars, whilst believed to be accurate are set out as a general outline only for guidance and do not constitute any part of an offer or contract. Intending purchasers should not rely on them as statements of representation of fact, but must satisfy themselves by inspection or otherwise as to their accuracy. No person in this firm's employment has the authority to make or give any representation or warranty in respect of the property.